

Silver Cross®

Cove

Chassis & Seat
Instruction Manual

IMPORTANT – READ CAREFULLY AND KEEP FOR FUTURE REFERENCE

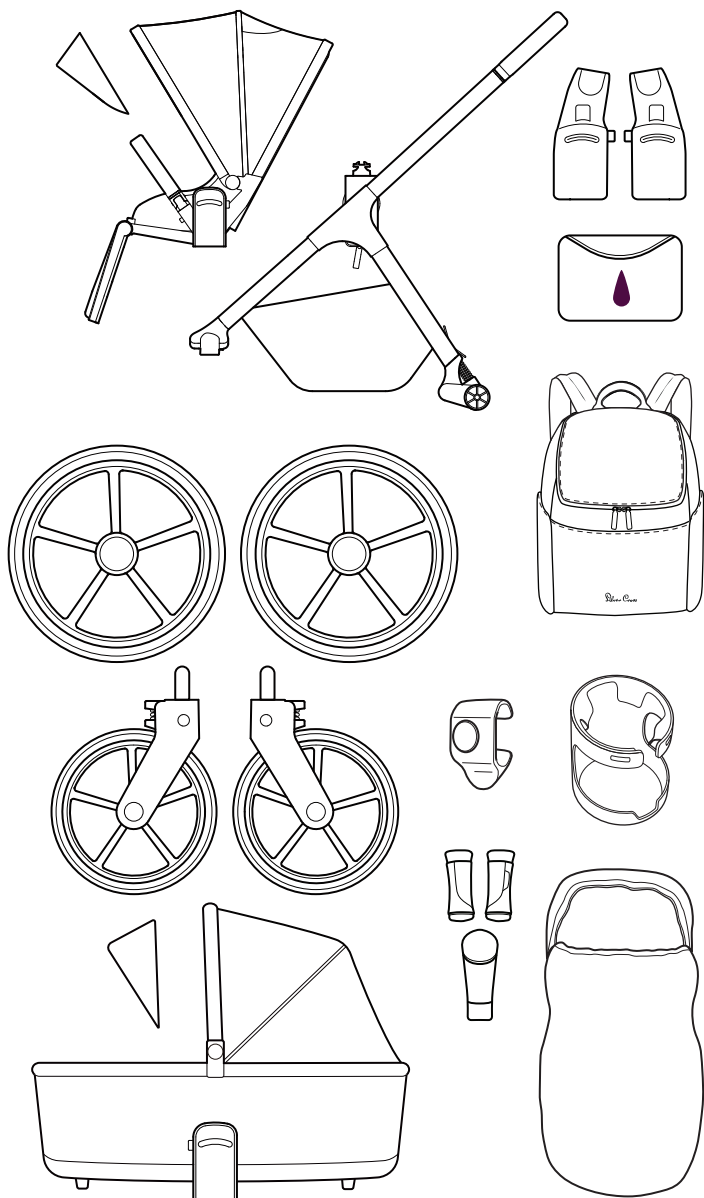

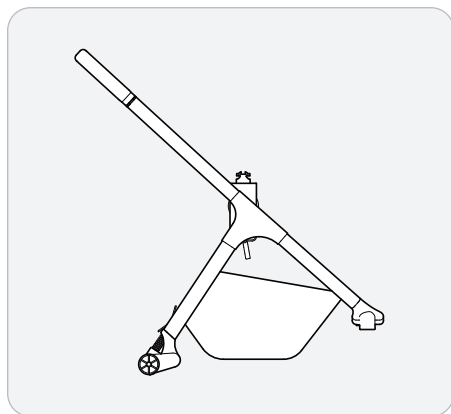

1.1

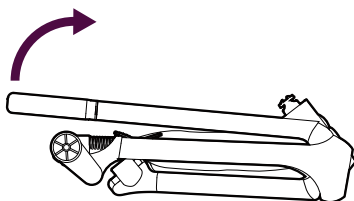

1.2

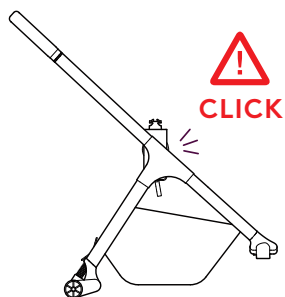

2.1

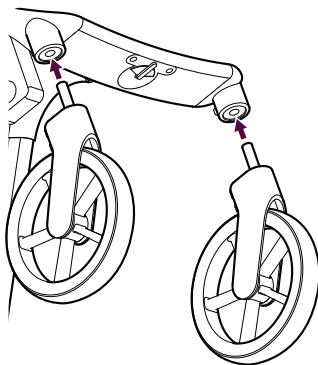

2.2

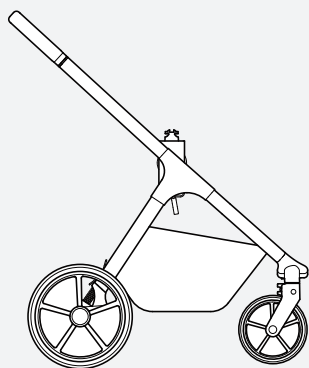
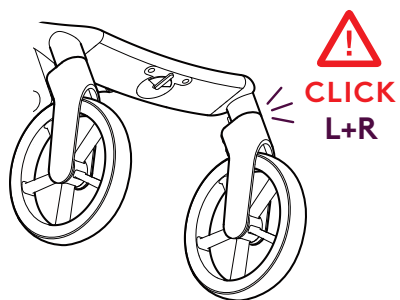

3.1

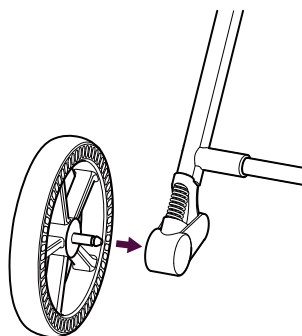

3.2

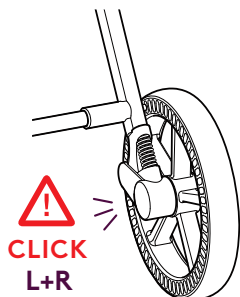

4.1

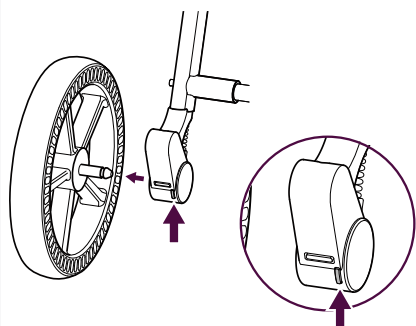

4.2

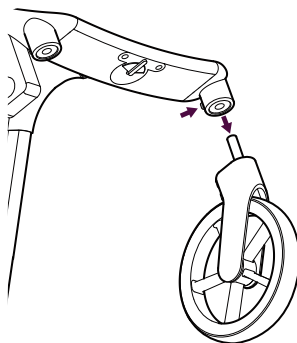

5.1

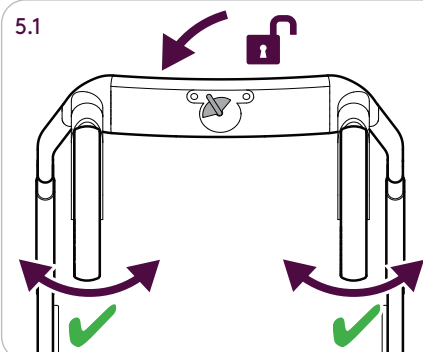

5.2

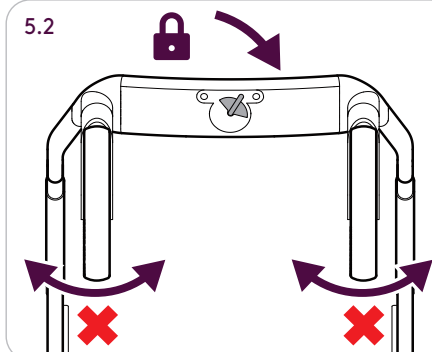

6.1

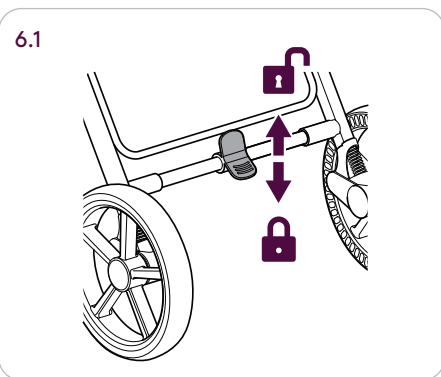

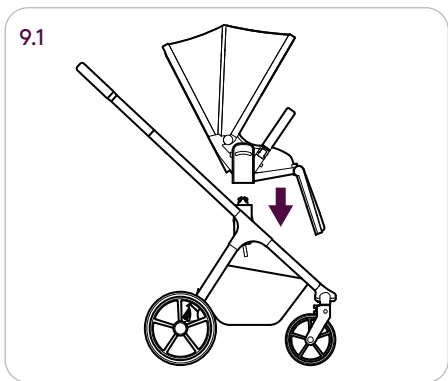
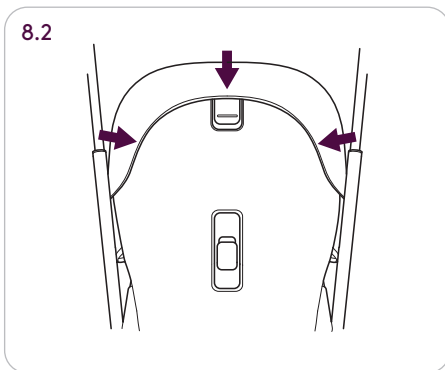
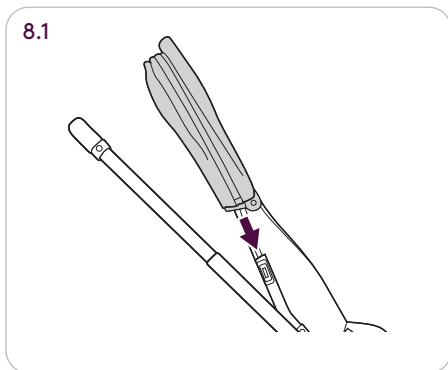
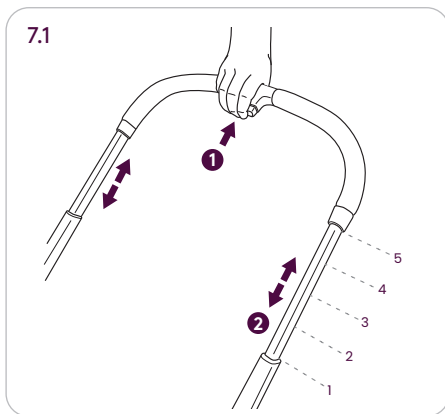
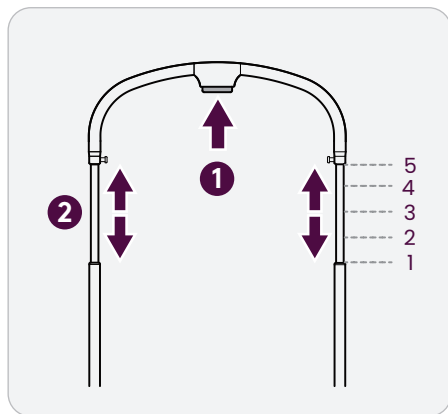

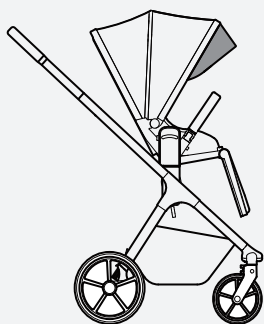

10.1



10.2

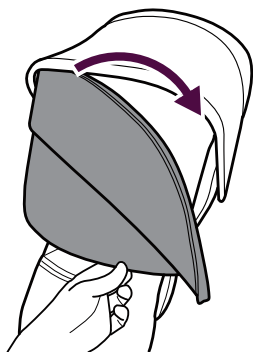

10.3

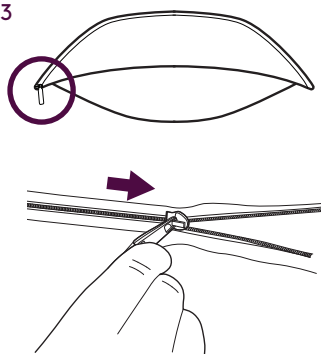

10.4



11.1

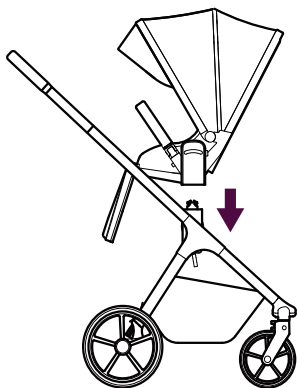

11.2



12.1

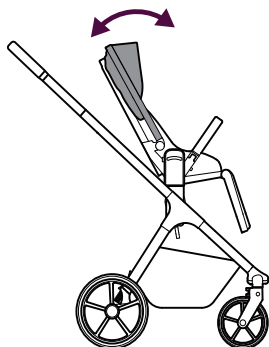

12.2

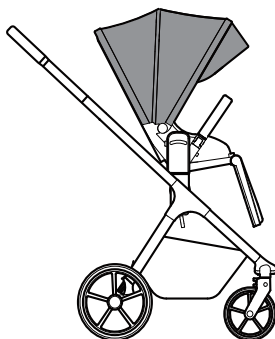

13.1

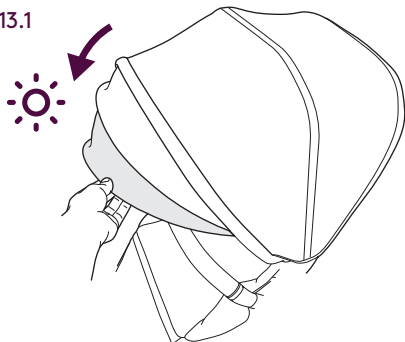

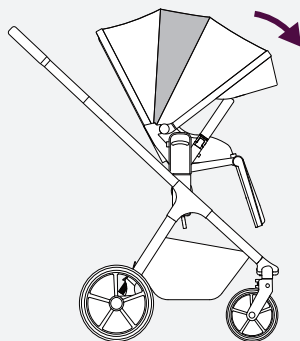
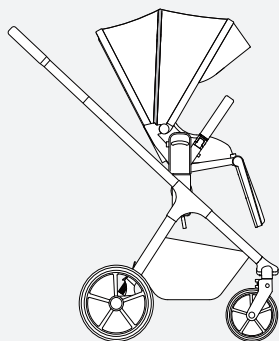

14.1

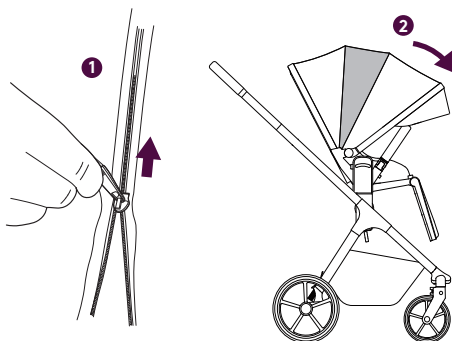
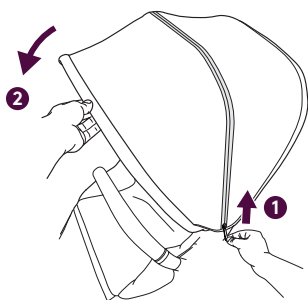

15.1

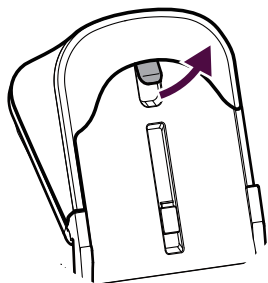

15.2

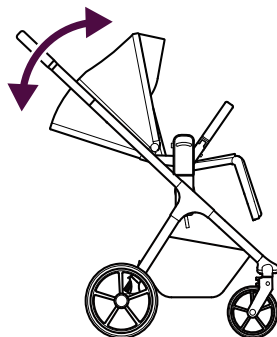

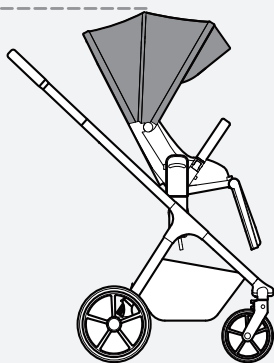
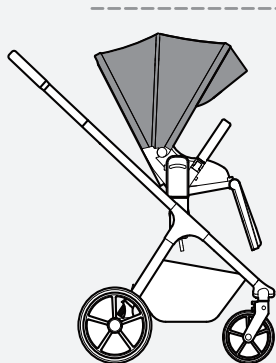

16.1

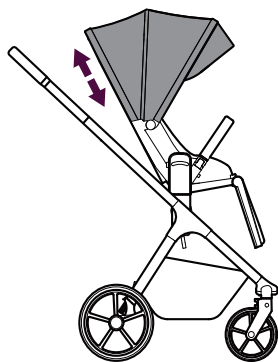

16.2



16.3

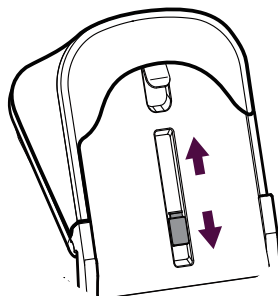



17.1

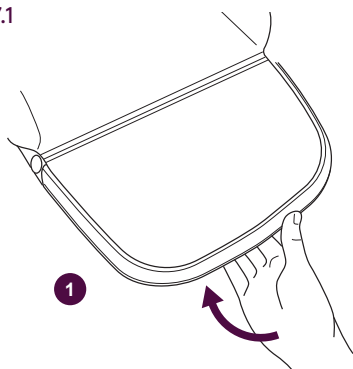

17.2

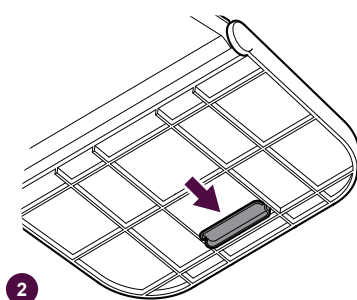

17.3

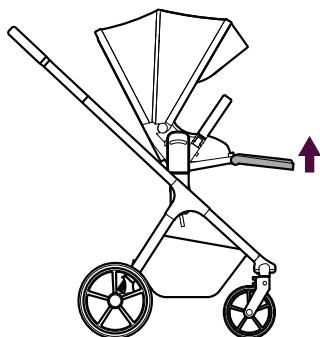

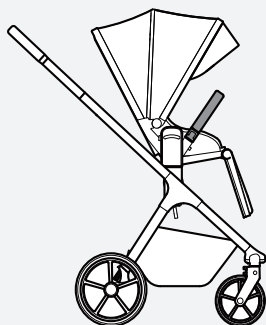

18.1

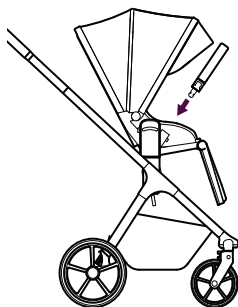

18.2

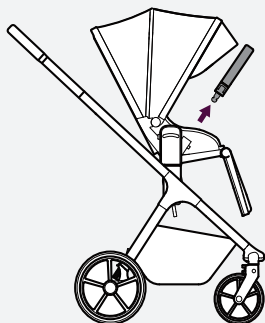
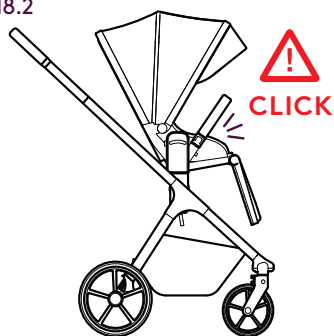

19.1

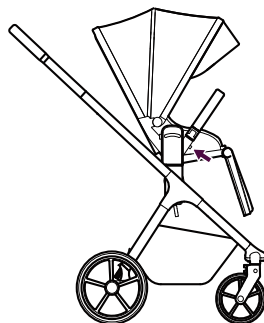

19.2

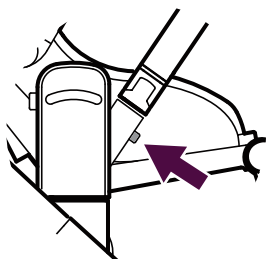

19.3

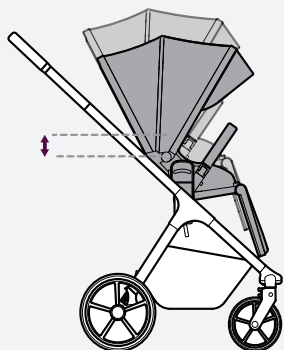
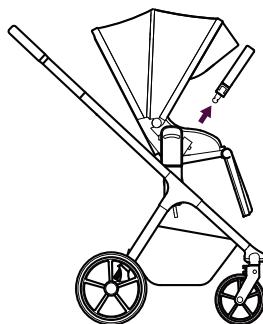

20.1

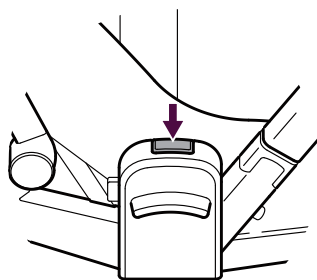

20.2

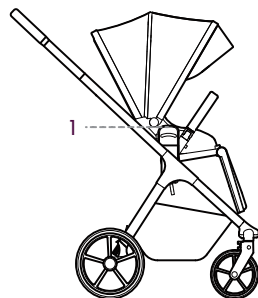
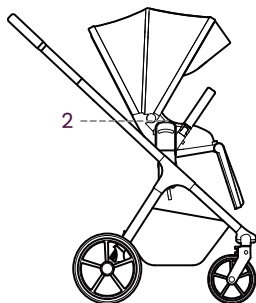
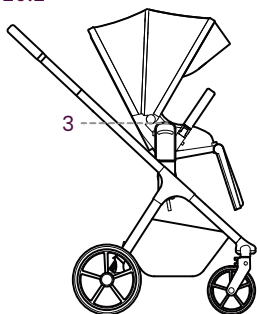

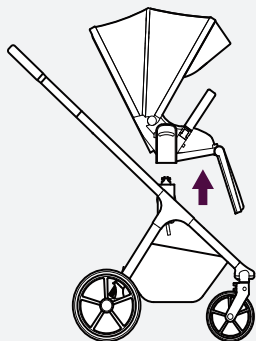

21.1

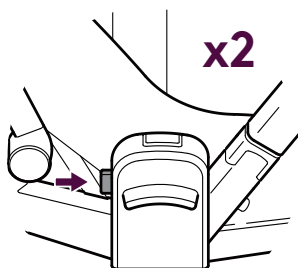

21.2

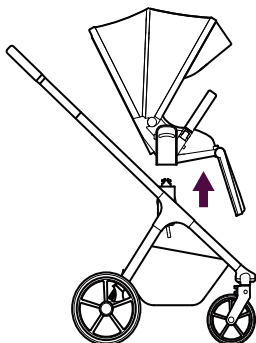

22.1

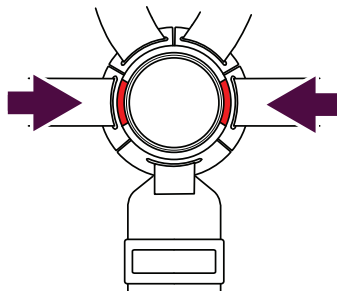

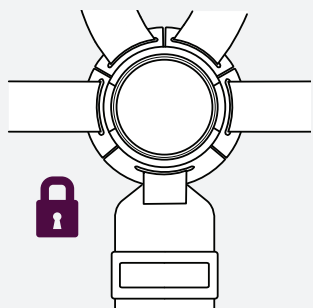

23.1

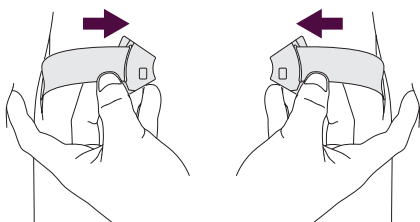

23.2

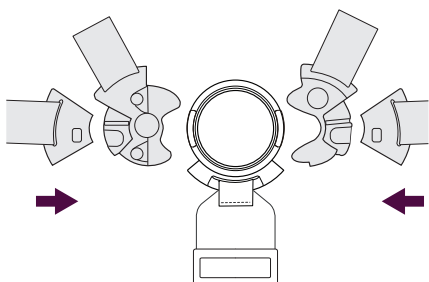

23.3

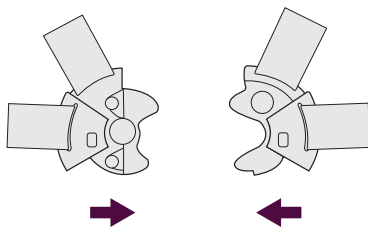

23.4

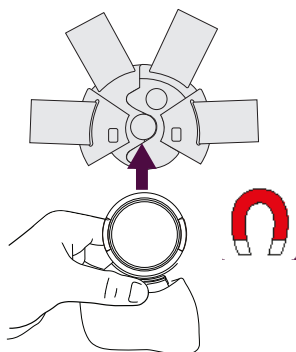

23.5

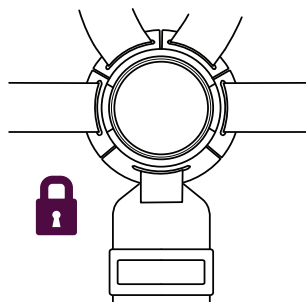

23.6

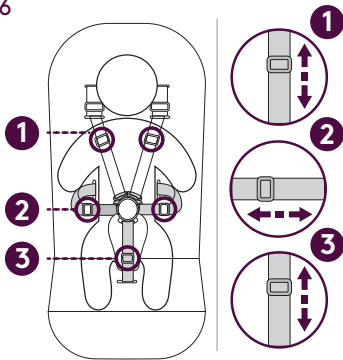

23.7

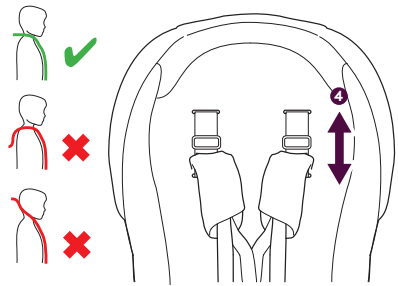

24.1

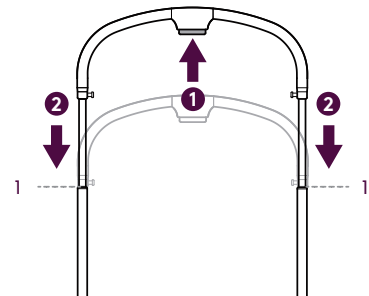

24.2

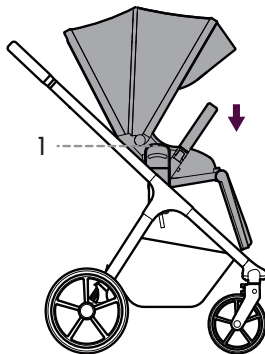

24.3

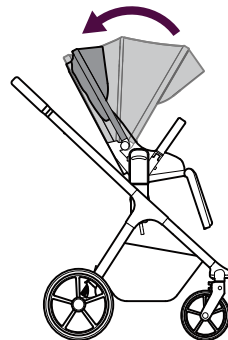

24.4



24.5

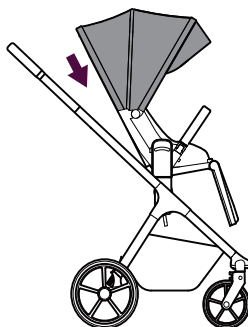

24.6

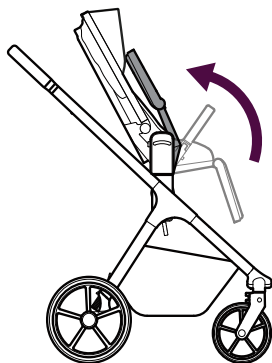

24.7

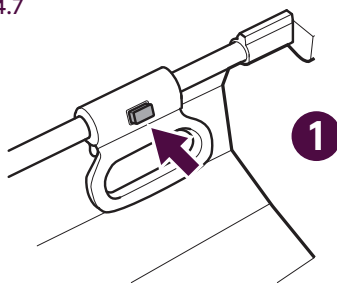

24.8



24.9



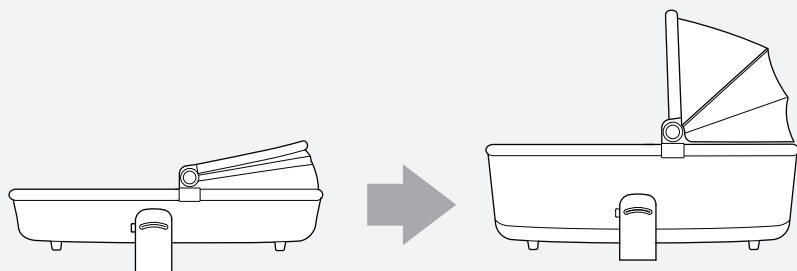

25.1

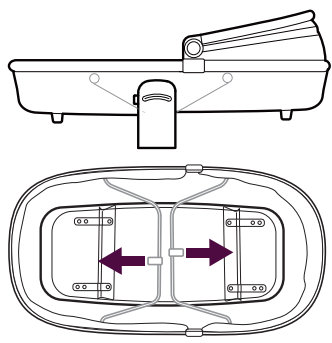

25.2

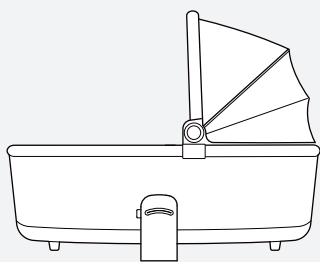
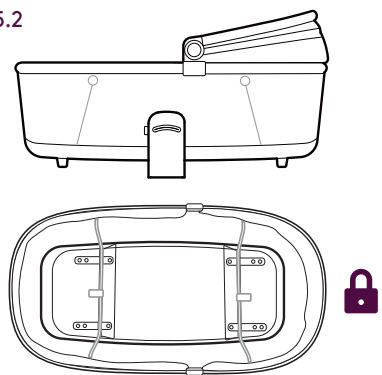

26.1

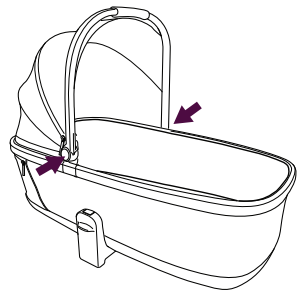

26.2

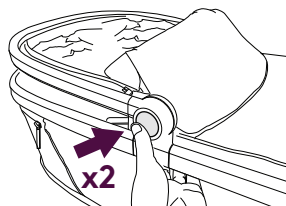

26.3

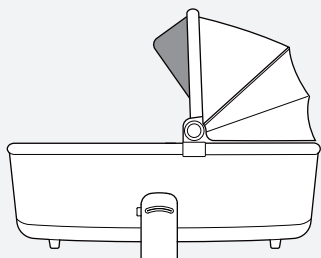
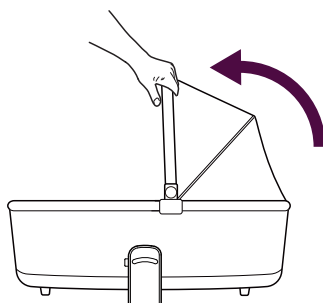

27.1



27.2

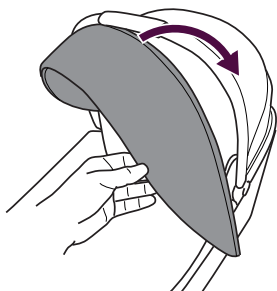

27.3

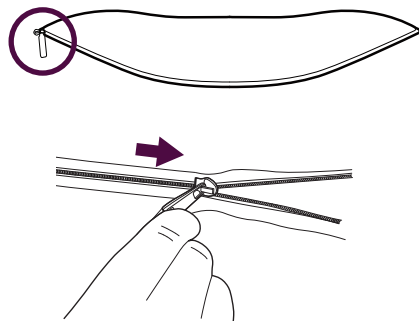

27.4

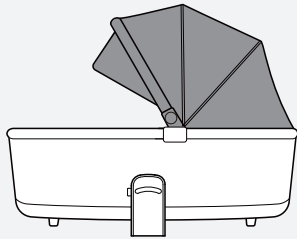
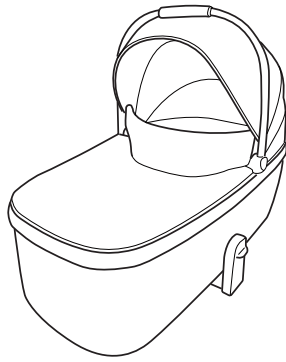

28.1

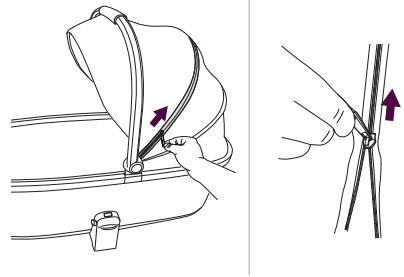

28.2

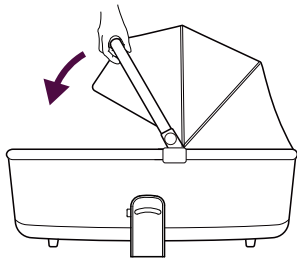

28.3

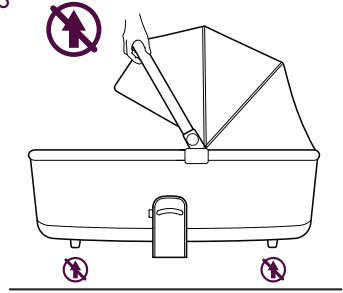

28.4

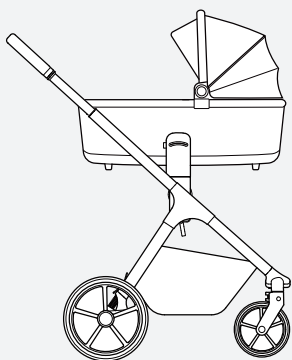
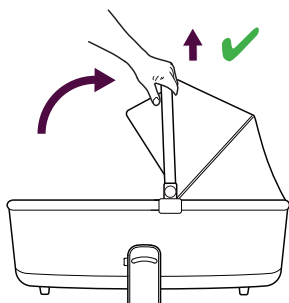

29.1

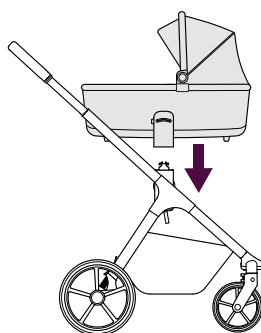

29.2

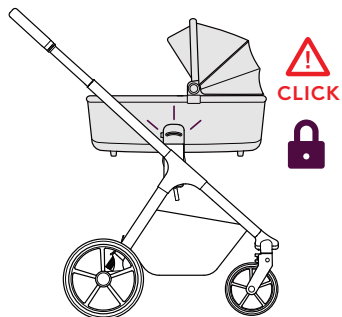

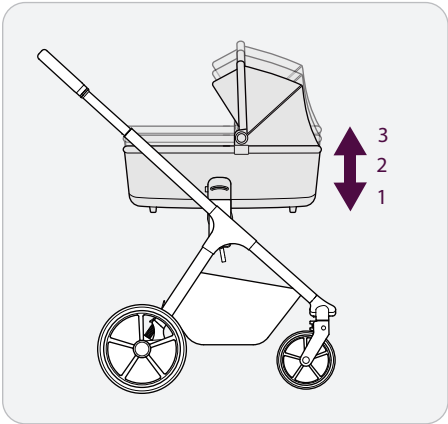

30.1

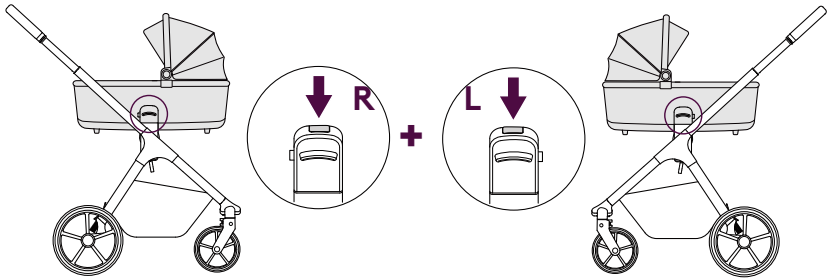

30.2

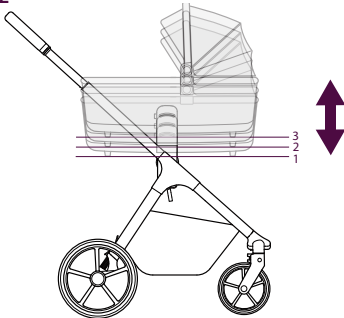

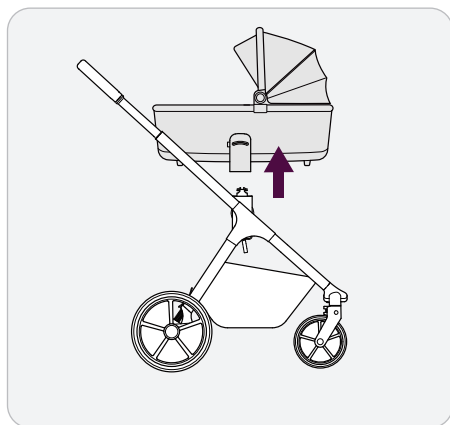

31.1

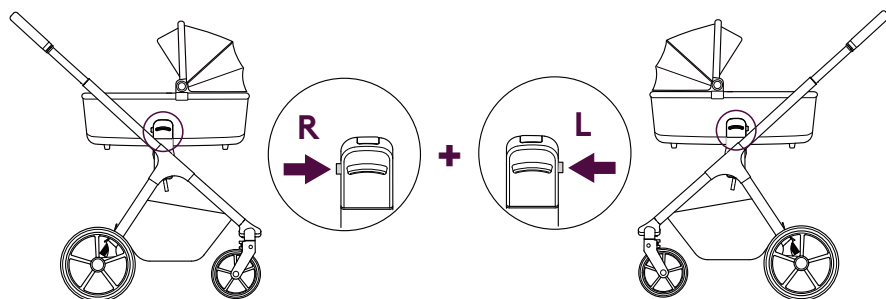

31.2

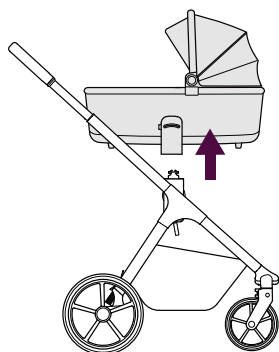

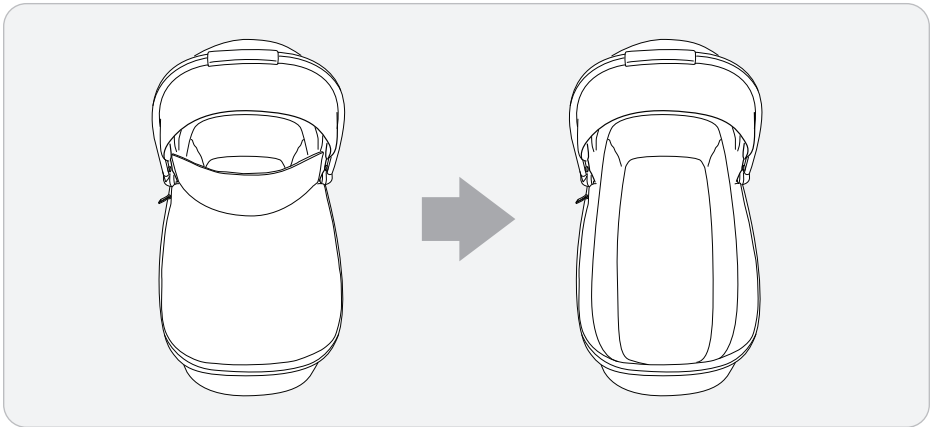
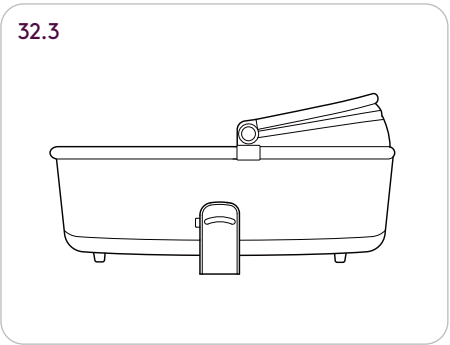
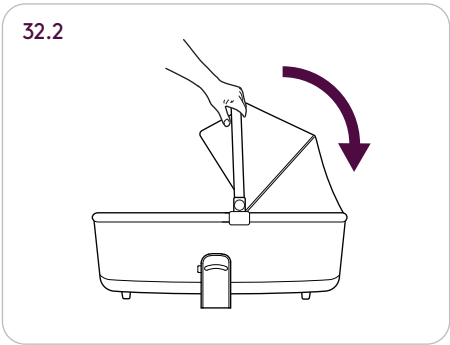
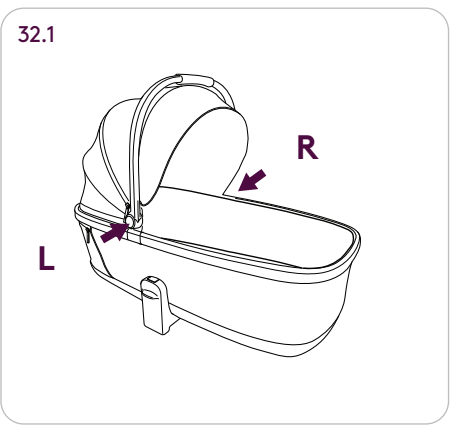
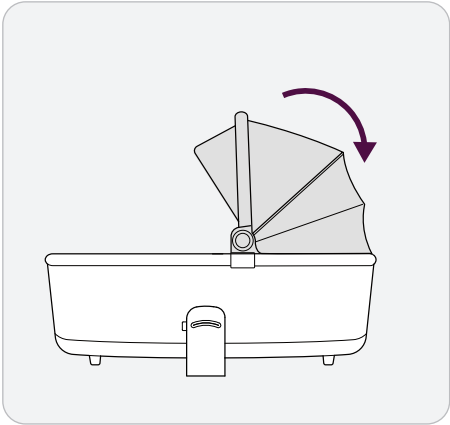

33.1

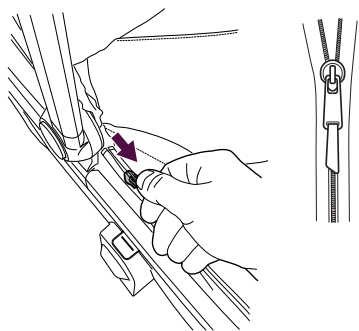

33.2

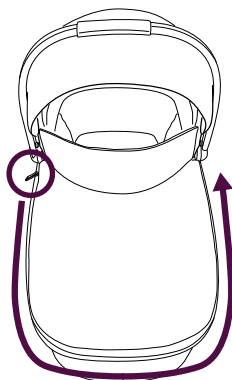

33.3

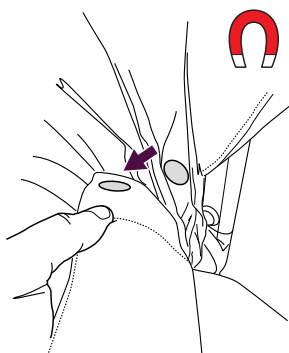

34.1

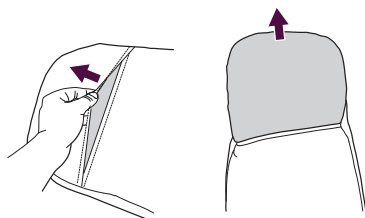
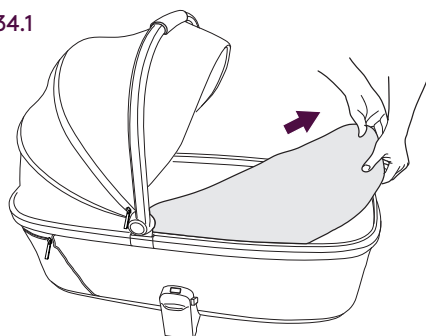

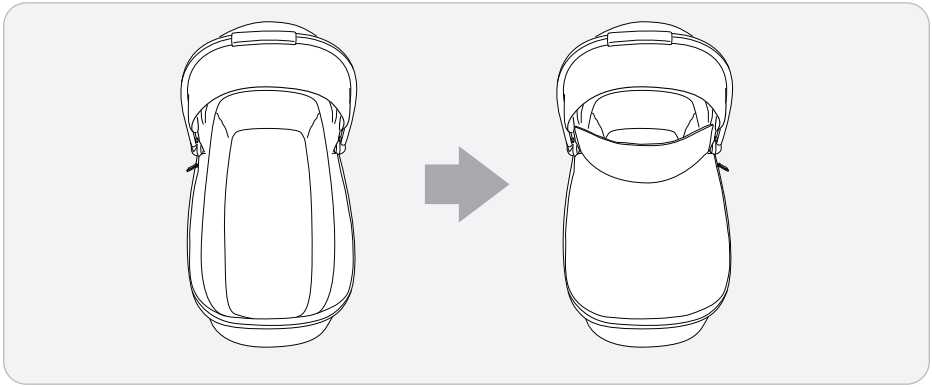

35.1

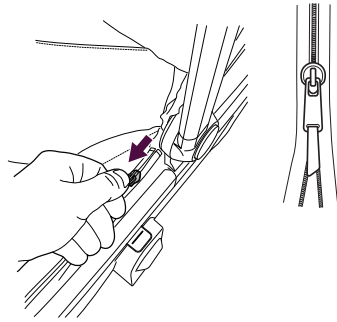

35.2

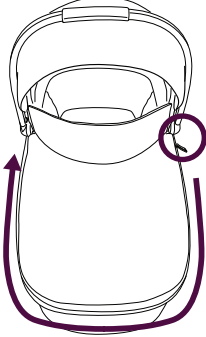

35.3

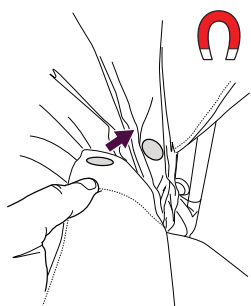

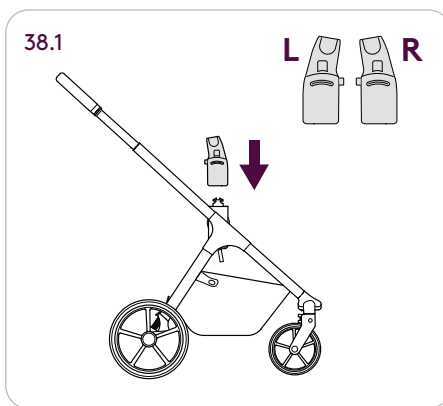
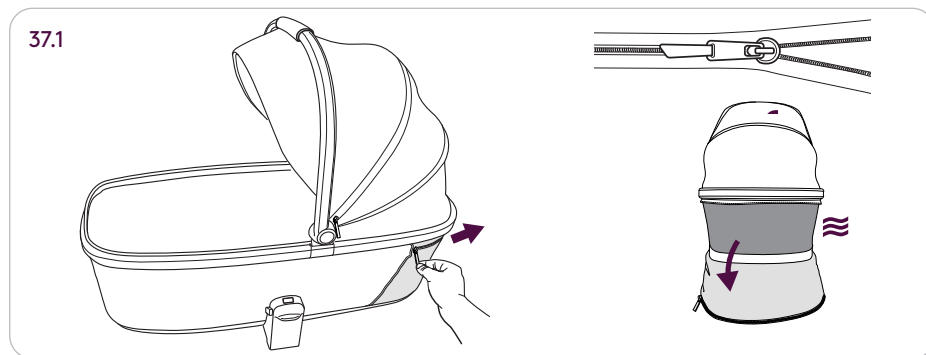
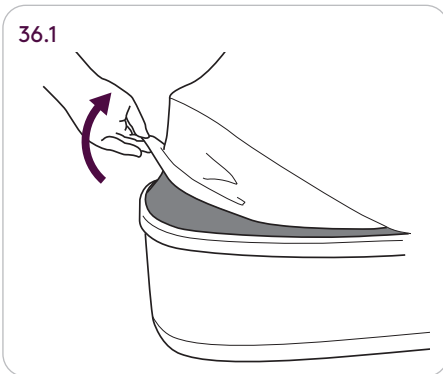
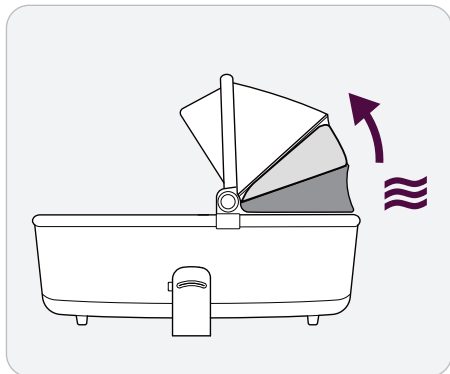

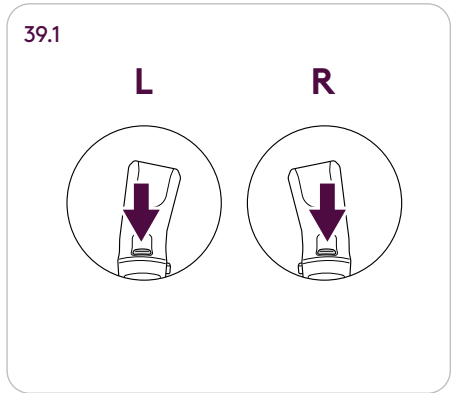
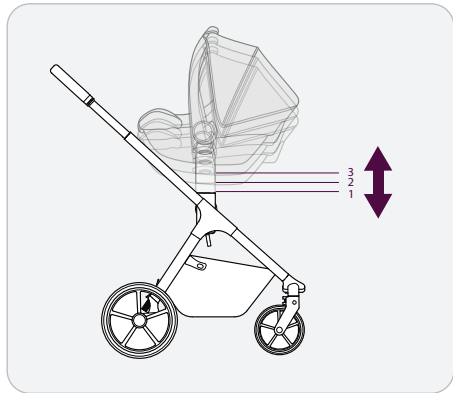
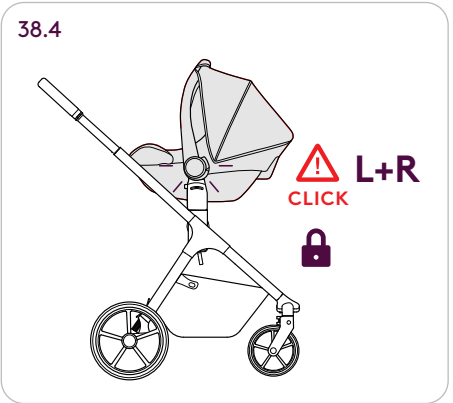
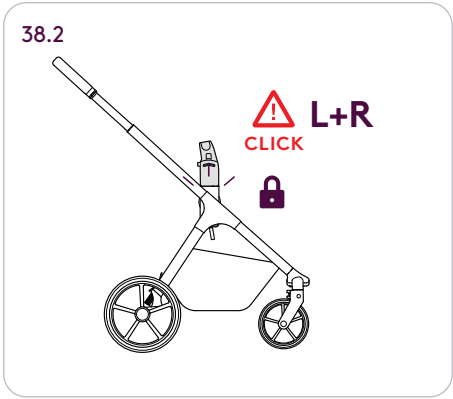

39.2

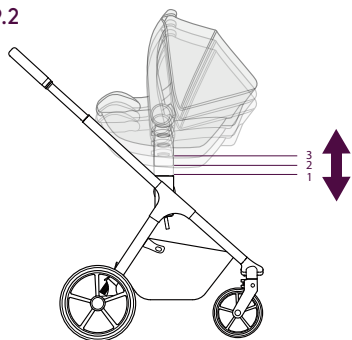

40.1

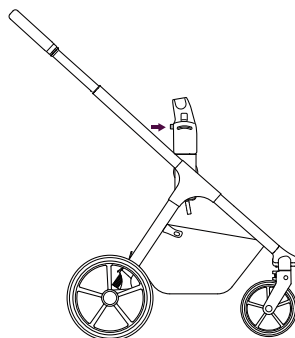

40.2

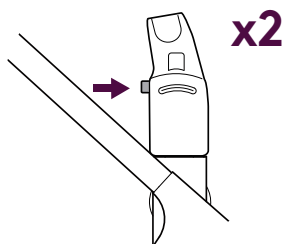

40.3

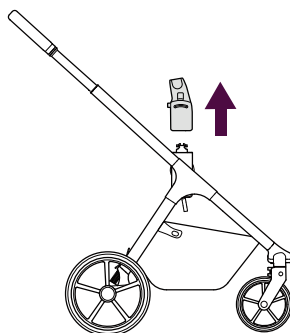

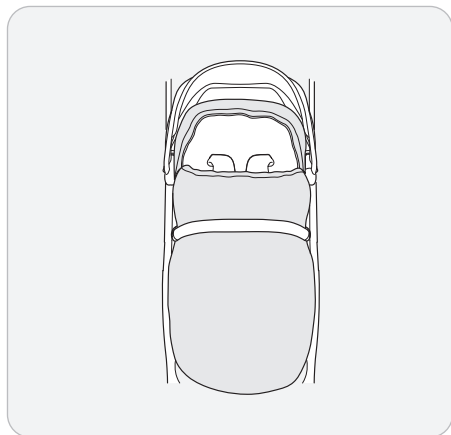

41.1

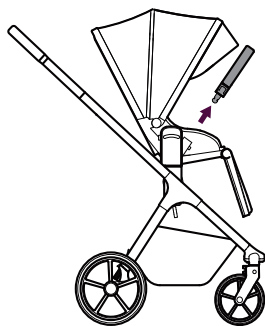

41.2

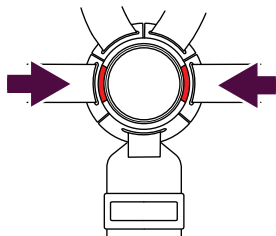

41.3

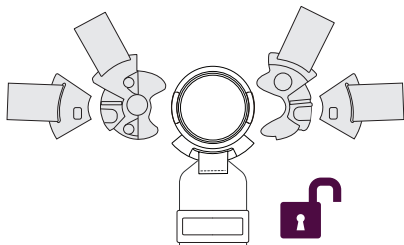

41.4

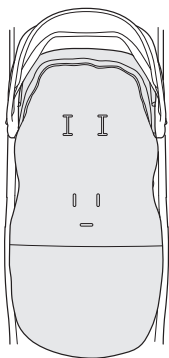

41.5

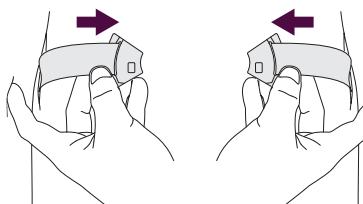

41.6

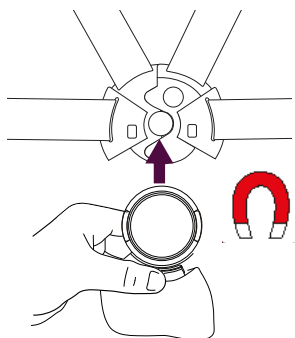

41.7

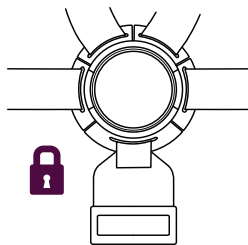

41.8

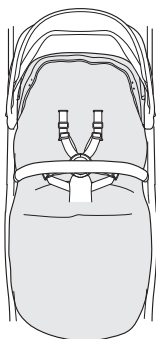

41.9

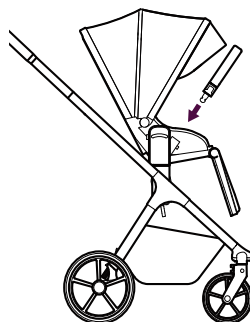

41.10

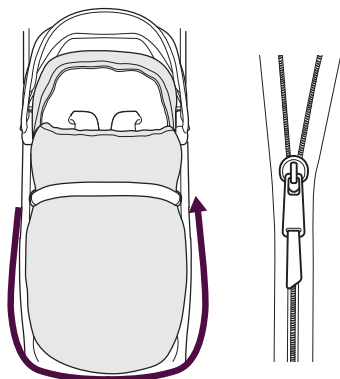

41.11

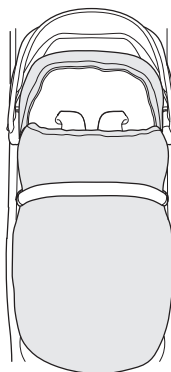

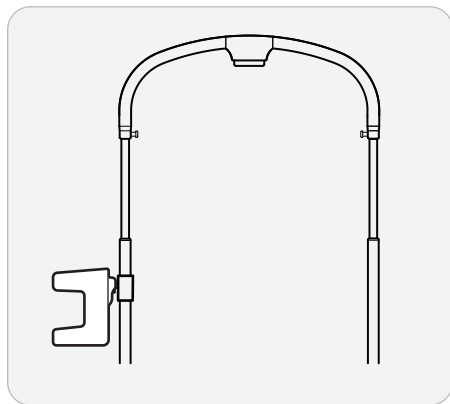

42.1

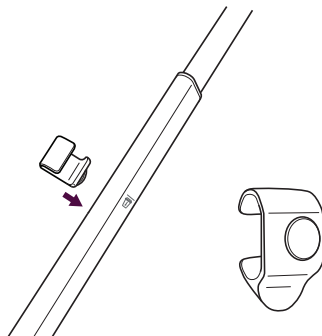

42.2

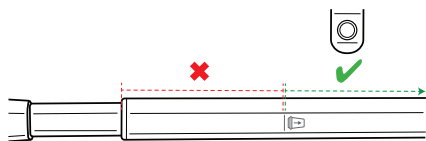

42.3

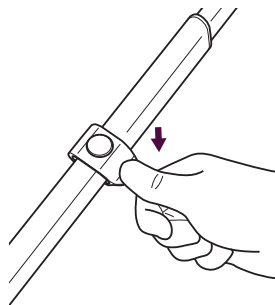

42.4

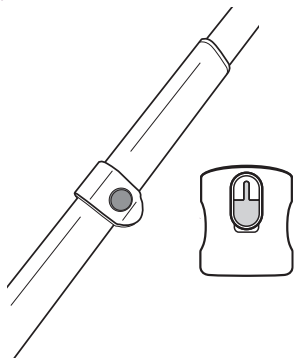

42.5

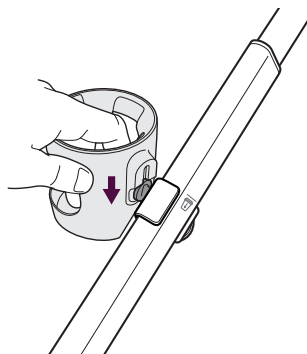

42.6

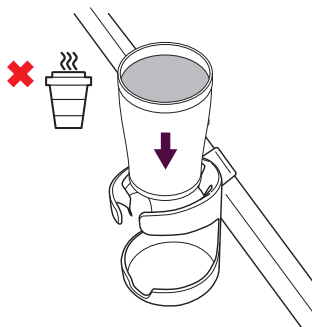

43.1

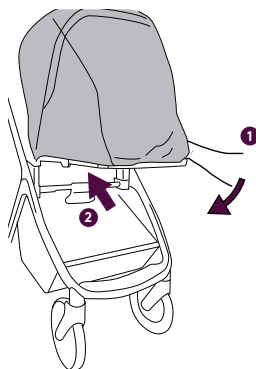

43.2

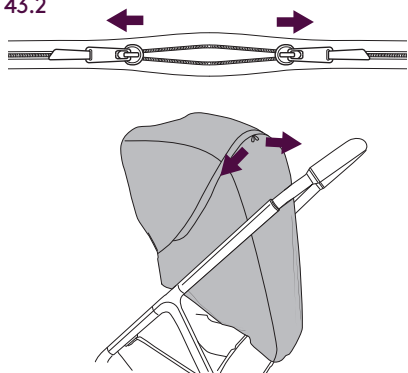

43.3

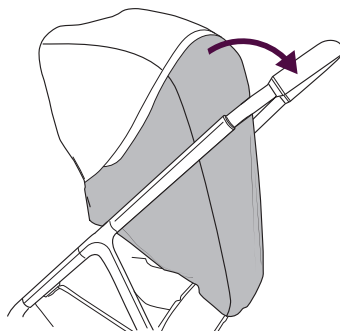

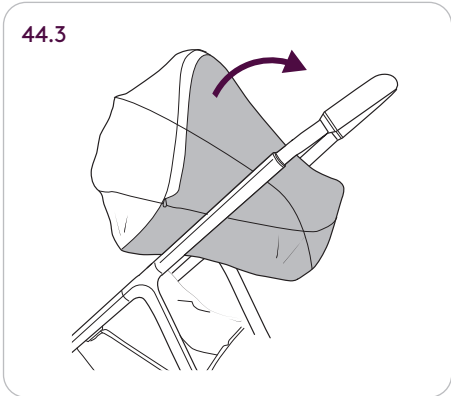
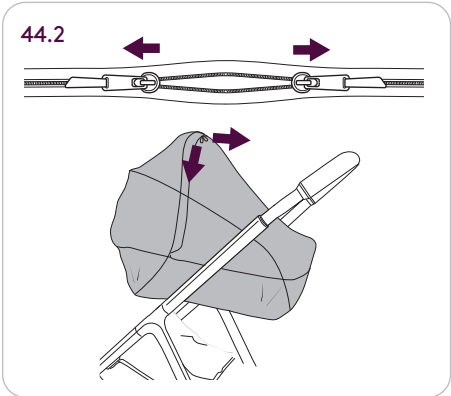
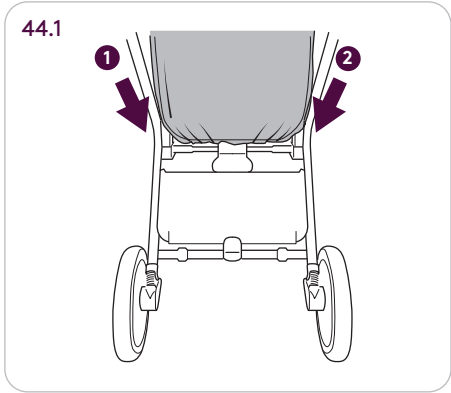
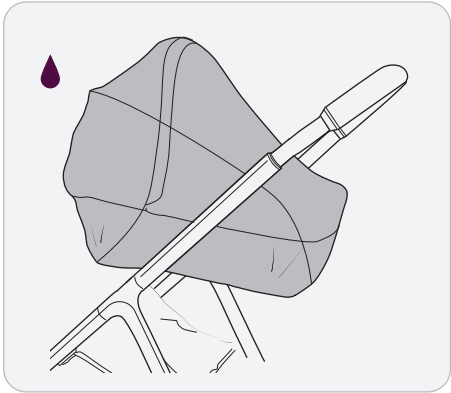

EN

TRAVEL SYSTEM

These instructions are important.

Read these instructions before use and keep them for future reference. The child's safety may be affected if you do not follow these instructions.

Your Cove travel system is a high quality Silver Cross product. It meets current safety standards and care and regular light maintenance will ensure its long service.

If somebody unfamiliar is using your Cove travel system, always ensure that they read these instructions carefully so that they understand how the product works best.

The Cove travel system is designed and tested to be used with the Cove Pushchair Seat, Cove Carrycot, and compatible accessories supplied separately including a Ride-on-Board and Car Seats.

SAFETY NOTES

The Cove travel system complies with EN1888-2:2018+A1:2022.

If you have any problems with this product, please contact your Silver Cross retailer who will take appropriate action.

Safety of the Child is your responsibility.

WARNINGS

1. Never leave the child unattended.
2. Ensure that all the locking devices are engaged before use.
3. To avoid injury, ensure that the child is kept away when folding and unfolding this product.
4. Do not let the child play with this product.
5. Always use the restraint system.
6. Check that the pram body, seat unit or car seat attachment devices are correctly engaged before use.
7. This product is not suitable for running or skating.
8. This travel system is suitable from birth up to 9kg or 6 months old, whichever comes first with the carrycot; and from birth up to 22kg or 4 years whichever comes first with the pushchair seat.
9. Always use the most reclined position for a newborn baby.
10. Do not add a mattress other than the one provided
11. Always apply the parking brake when placing and removing the child.

12. Maximum capacity for basket: 5kg.

Maximum capacity for cup holder: 340g.

13. Any load attached to the handle and/or backrest and/or sides of the vehicle will affect stability of the vehicle.

14. Do not carry more than one child in this pushchair.

15. For car seats used in conjunction with a chassis, this vehicle does not replace a cot or a bed. Should your child need to sleep, then it should be placed in a suitable pram body, cot or bed.

16. Only replacement parts and accessories approved by silver cross should be used.

Do not lift pushchair seat via the bumper bar whilst a child is in place. The bumper bar is not a carry handle. Always ensure the bumper bar is attached when your child is in the pushchair seat. Please ensure folding mechanisms are kept clear to avoid possible finger entrapments or injuries to parts of the body.

CARRYCOT

Read these instructions before use and keep them for future reference. The child's safety may be affected if you do not follow these instructions.

Your Cove Carrycot is a high quality Silver Cross product. It meets current safety standards and care and regular light maintenance will ensure its long service.

If somebody unfamiliar is using your Cove Carrycot, always ensure that they read these instructions carefully so that they understand how the product works best.

SAFETY NOTES

The Cove Carrycot complies with EN1466:2023

If you have any problems with the carrycot, please contact your Silver Cross retailer who will take appropriate action.

Safety of the Child is your responsibility.

WARNINGS

1. Only use on a firm, horizontal level, flat and dry surface.

2. Do not let other children play unattended near the carrycot.

3. Do not use if any part of the carrycot is broken, torn or missing.

4. This product is suitable only for a child who cannot sit up unaided, roll over and cannot push itself up on its hands and knees. maximum weight of the child: 9kg, or 6 months old, whichever comes first.

5. Only use replacement parts supplied and approved by silver cross.

6. Be aware of the risk of open fire and other sources of strong heat, such as electric bar fires, gas fires, etc. in the near vicinity of the carry cot.

7. The handles and the bottom of the carrycot should be inspected regularly for signs of damage and wear.

8. The carrycot is only to be used with the Silver Cross carrycot stand.

9. Before carrying or lifting, make sure that the handle is in the correct position of use.

10. The head of the child in the carrycot should never be lower than the body of the child.

11. Do not add a mattress other than the one provided

12. Be aware of hazard of hitting the baby e.g. when putting on floor, going through doors.

13. Do not add a mattress other than the one approved.

14. Do not leave anything in the carrycot that could present a danger of suffocation e.g. non-rigid toys, pillows.

15. Do not place the carrycot close to another product, which could present a danger of suffocation or strangulation, e.g. strings, blind/curtain cords.

16. Overheating can endanger the life of your child! take into account the ambient temperature and the child's clothing and ensure that the child is not too cold or too warm.

17. We recommend asking a health professional for advice on safe sleeping.

CARE & MAINTENANCE

Hardware – Always check your pushchair for signs of wear. Regularly lubricate all moving parts. Check for freedom of movement of all locking devices. Polish metal work with a clean, dry cloth.

Dirt and dust within moving mechanisms may be rinsed away with clean water. Do not soak or submerge.

Fabric items – Please refer to the washcare instructions on each individual item's washcare label.

Pushchair Seat – To clean, sponge area with warm soapy water. Rinse well with clean

water to avoid staining. Allow to dry naturally, away from direct heat and strong sunlight.

Never machine wash, tumble dry, iron or bleach any of the fabric items or seat unit. A certain degree of fading may occur over time through everyday use.

CAR SEAT

These instructions are important.

For a list of compatible car seats please visit our website.

Never place the car seat in the car with the adaptors attached.

CUP HOLDER

These instructions are important.

Do not use cup holder with hot liquids.

The Silver Cross logo, featuring the brand name in a stylized, cursive script.

UK

Silver Cross (UK) Ltd.
Micklethorn, Broughton, Skipton,
North Yorkshire BD23 3JA

Silver Cross®

silvercrossbaby.com